

2022 EAST REGION WORKSHOP

January 18, 2022 Pearland, Texas



EAST REGION

**Sponsorship Exhibitor
Opportunities**

2022 EAST REGION WORKSHOP

January 18, 2022 Pearland, Texas

EXHIBITOR OPPORTUNITIES

Meet your current and future customers...

The East Region Workshop offers you unparalleled opportunities to reach parks and recreation decision makers from Texas. It is also a chance for your company to make contact and to set the stage for sales. The Workshop and Exhibitors' Expo have been designed to maximize contact between our delegates and exhibitors.

Exhibitors' Expo Hours

Exhibitors' Expo Set Up:

Monday, January 17 8:00 am - 4:00 pm

Exhibitors' Expo Hours:

Monday, January 18 8:00 am - 3:00 pm

Tear Down:

Monday, January 18 3:00 pm - 6:00 pm

Exhibitor Benefits

1. Two representatives are invited to join the delegates at the Workshop and lunch provided. Additional representatives may participate (additional cost)
2. Representatives are invited to attend the Keynote and TRAPS East Region education sessions.
3. Acknowledgement throughout door prize draws at the Exhibitors' Expo.
4. Listing and link on the website.
5. Exhibitor provided promotional item insert in the delegate bags.

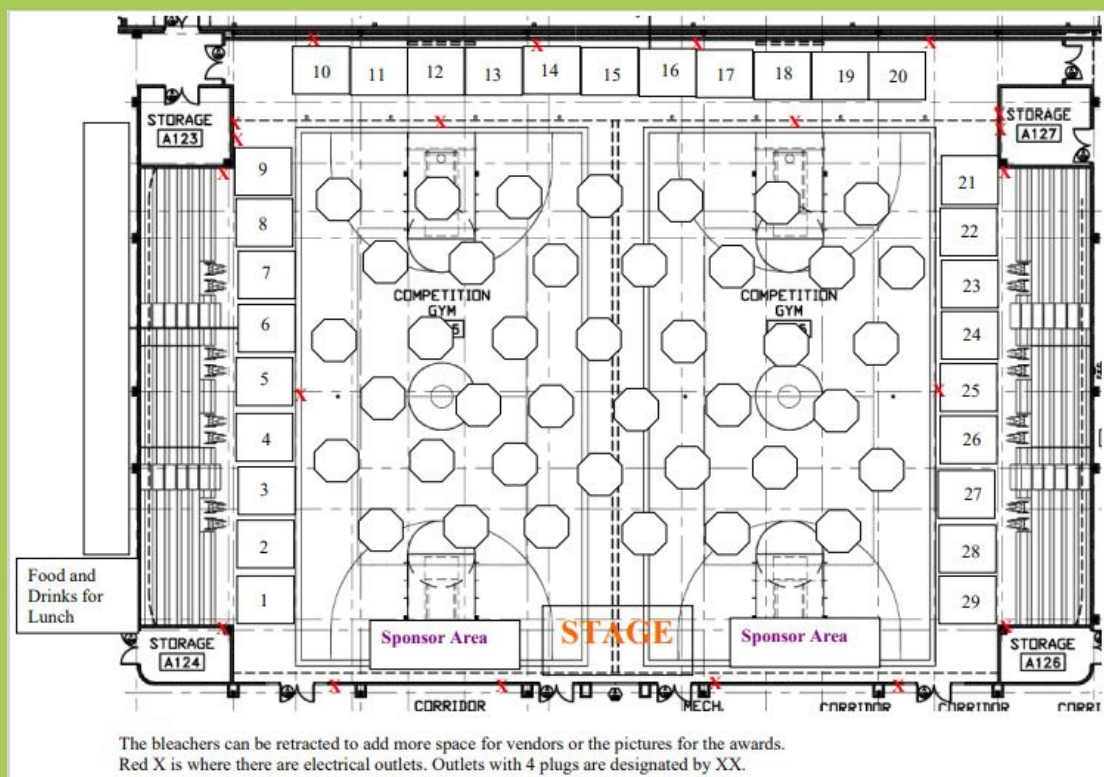

2022 EAST REGION WORKSHOP

January 18, 2022 Pearland, Texas

Sponsor Levels

Title Sponsorship (Includes 2 Vendor Booths (10x20)/2 meals)	\$3500
Playground Maintenance Academy (Includes 2 Vendor Booths (10x20)/2 meals)	\$2500
Lunch	\$2500
Coffee/Breaks (2)	\$1000
Room Sponsors (5)	\$500
Vendor Booths (29 Total) (Includes 10 x 10 space)	\$200

Online Payments Accepted at:

<https://membership.traps.org/store/ListProducts.aspx?catid=808706>

EXHIBITOR GUIDELINES

BOOTH SETUP AND UNLOADING

All move-ins and move-outs must be accomplished through the loading/unloading area at the back of the Recreation Center. Exhibitors will be able to set-up their booth space(s) between 8 am and 4 pm on Monday, January 17th. Exhibitors must be set-up and ready by 8 am on Tuesday, January 18th and remain open until 3 pm on January 18th. The Workshop host site reserves the right to make adjustments to booth arrangements in the event of facility issues and/or equipment needs. Please note that exhibitors will not be allowed to break-down their booth(s) until 3 pm and must be completely moved out by 6 pm on Tuesday, January 18th. Exhibitors must remove all displays, props, and handouts at the conclusion of the Workshop. Facility questions not covered in these guidelines may be directed to Kevin Carter at (713) 823-3780.

BOOTH ARRANGEMENT

Indoor booth spaces are 10' x 10' in size. Booths are provided with (1) table and (2) chairs. Exhibitors must furnish their own displays, pipe and drapes (if desired), equipment, supplies and extension cords. Please ensure that your booth activities remain within the confines of your booth space and do not interfere with neighboring exhibitors. Any product demonstrations must be performed in a safe manner, and within a sufficient amount of space. All copies of handouts and materials must be made prior to the event. No copying/printing services will be provided.

BOOTH LAYOUT

Since some of our exhibitors may provide similar products and services, we will do everything possible to not arrange like booths in close proximity to each other. Please note that due to the limited spaces available, this may not always be feasible.

SECURITY

The area will be secured for the evening after 4 pm on January 17th. There will not be any additional security guards provided. The property and materials in each booth space shall be at all times the responsibility of the exhibitor.

SCHEDULE AT A GLANCE

Monday January 17

8:00 - 4:00

Exhibitor Set up

Tuesday January 18

7:00 – 8:00

Check-In

8:00 – 8:30

Welcome/Keynote

8:30 – 8:45

Coffee Time

8:45 – 10:00

Session A

10:00 – 10:30

Coffee Time/ Vendors

10:30 – 11:45

Session B

11:45 – 1:00

Lunch/ Vendors

1:00 – 2:15

Session C

1:00 – 4:00

Playground Maintenance Academy

2:15 – 2:45

Break/ Vendors

2:45 – 4:00

Session D

EXHIBIT HALL LOCATION

Pearland Recreation Center & Natatorium

4141 Bailey Rd.

Pearland, TX 7584



EAST REGION
TEXAS RECREATION & PARK SOCIETY